

Part. S0846

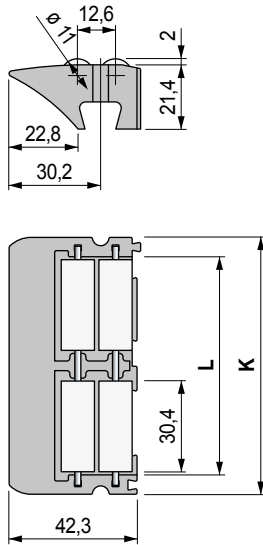

NEW

End transfer module (with lip)



K mm	L mm	Code	Weight kg
85	72	645573	0,046
115	102	645583	0,063

- Material: frame in acetal Rex-HP™ (dark grey) very low coefficient of friction, rollers in acetal POM (white). Roller pins in austenitic stainless steel.
- Modularity: snap-on assembly with Part. S0847 - S0848 - S0849.
- Packaging: 10 pieces.

Part. S0847



NEW

End transfer module (with lip)

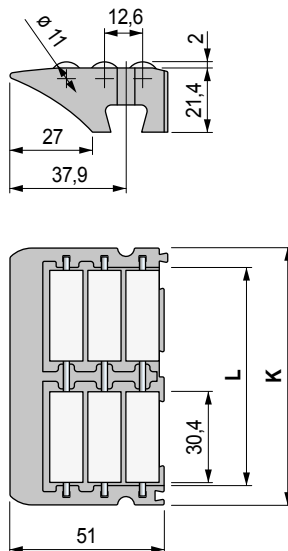

K mm	L mm	Code	Weight kg
85	72	645593	0,062
115	102	645603	0,085

- Material: frame in acetal Rex-HP™ (dark grey) very low coefficient of friction, rollers in acetal POM (white). Roller pins in austenitic stainless steel.
- Modularity: snap-on assembly with Part. S0846 - S0848 - S0849.
- Packaging: 10 pieces.

• Assembly Part. S0846 - S0846

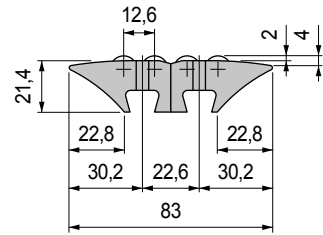

• Assembly Part. S0846 - S0847

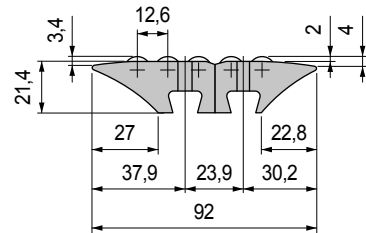

• Assembly Part. S0846 - S0848

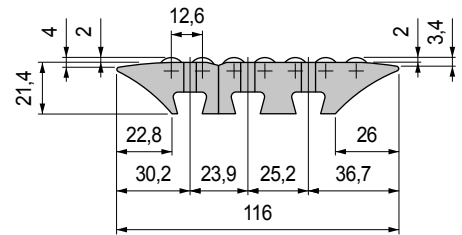

• Assembly Part. S0846 - S0849

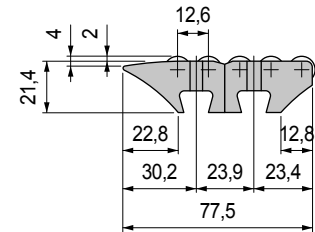

• Assembly Part. S0847 - S0847

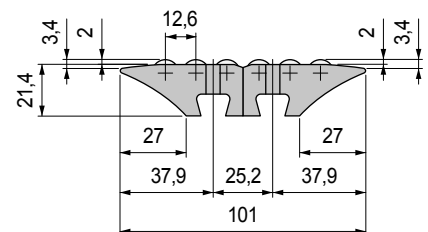

- Best Seller
- Standard
- On request: minimum quantity may apply. Consult our Customer Service for availability.

Item code for order = Part. + Code